



STARBOARD CRE
LOCAL • INDEPENDENT • ENTREPRENEURIAL

For Lease

217 B St.

San Mateo, CA 94014

Great location in downtown San Mateo.

Frank Vella

frank@starboardcre.com

650.464.8062



STARBOARDCRE.COM

OFC. PHONE 415.765.6900

49 POWELL STREET, SAN FRANCISCO, CA 94102

BUILDING OVERVIEW

For Lease

Building: 217 B Street, San Mateo
Space: 2nd Floor
Type: Office
Asking Price: \$3.85 /SQFT

Experience modern work comfort in our 2nd-floor office suites, bathed in abundant natural light. Enjoy an open space layout ideal for dynamic collaboration, all situated in the heart of downtown San Mateo.

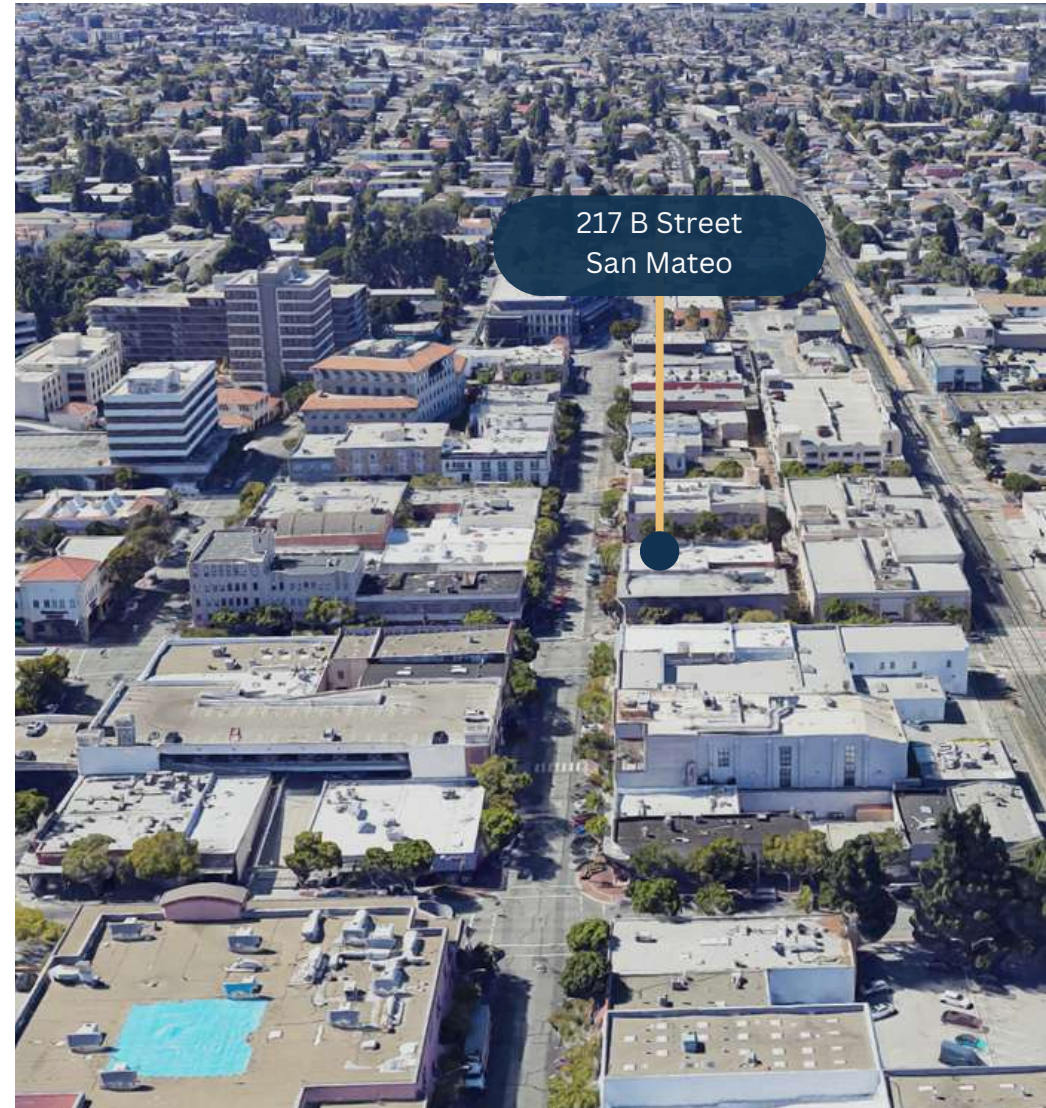

SUITE 1 & 2 | FLOORPLAN

For Lease

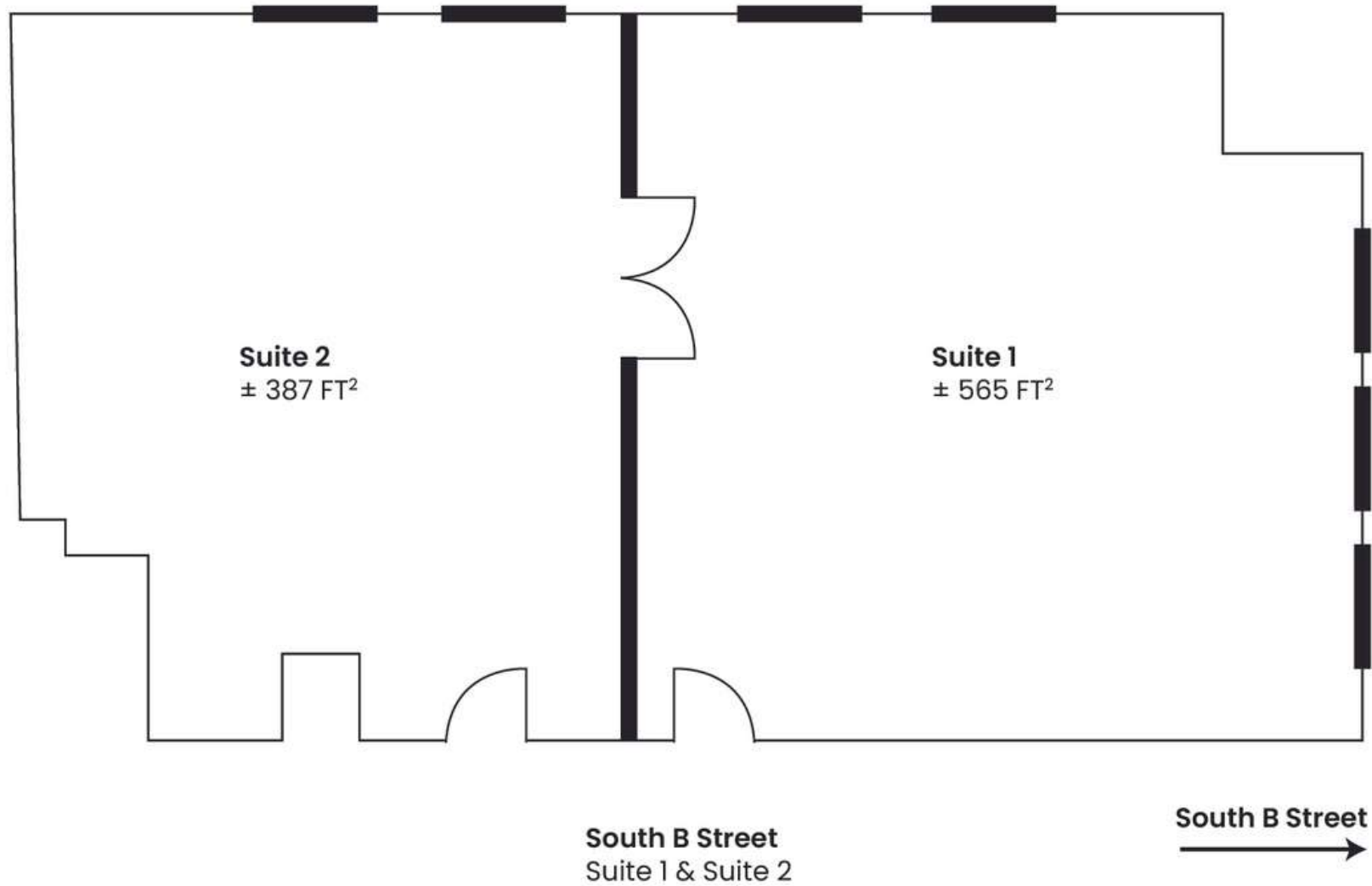

SUITE 3 & 4 | FLOORPLAN

For Lease

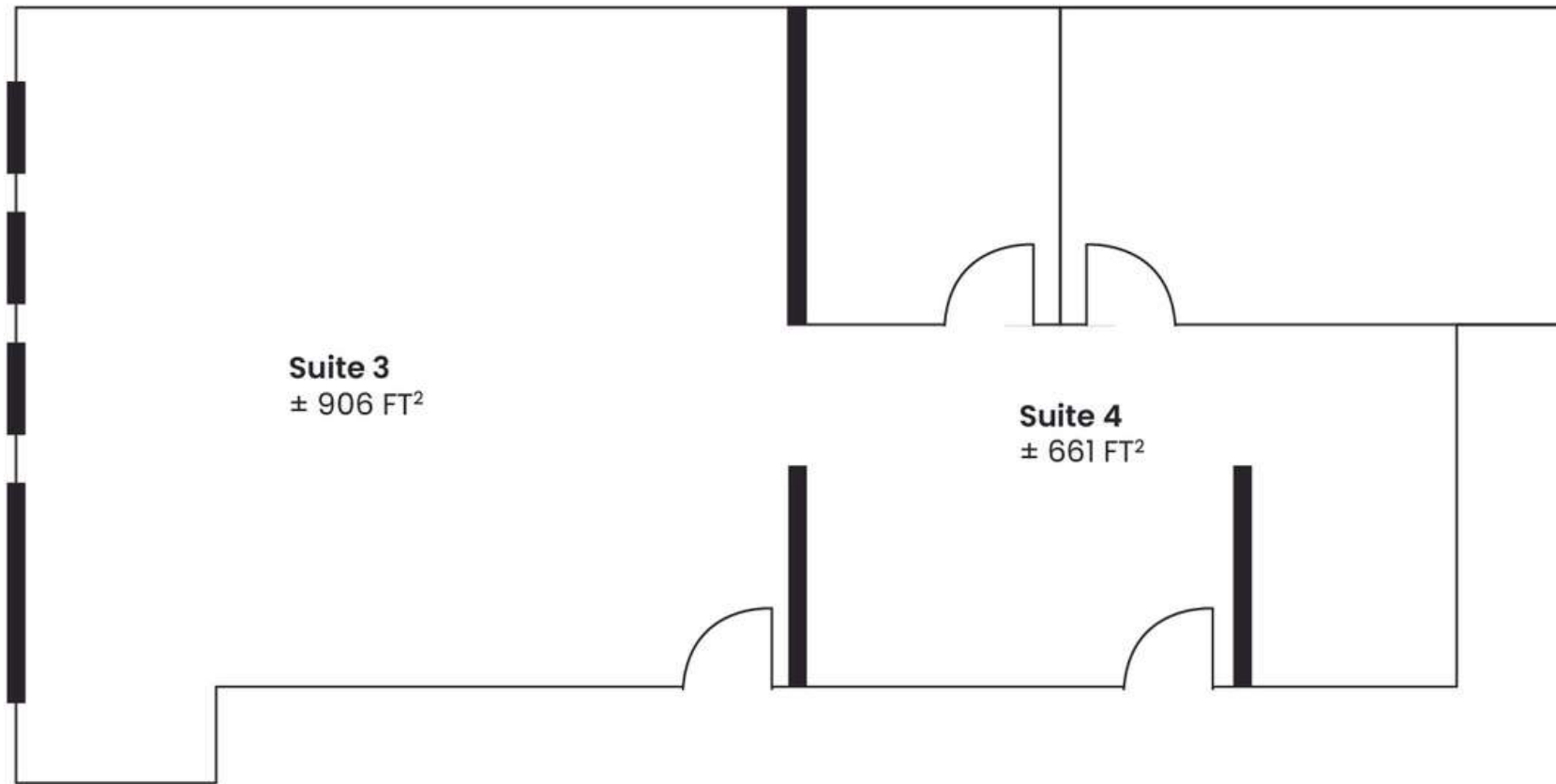

Suite 3
± 906 FT²

Suite 4
± 661 FT²

South B Street
Suite 3 & Suite 4





Frank Vella

Broker Associate
frank@starboardcre.com
CELL: 650.464.8062
OFFICE: 415.765.6900
CA DRE # 01104977

Call

View Profile



STARBOARD CRE
LOCAL • INDEPENDENT • ENTREPRENEURIAL

STARBOARDCRE.COM
OFC. PHONE 415.765.6900
49 POWELL STREET, SAN FRANCISCO, CA 94102



Unique Vision

We see what others miss

Local Market Leader

No one knows Northern
California like we do

Full-Service Firm

We do it all

Locally based, and technology-forward, our brokers are highly qualified experts backed by a full-service, in-house support team who understand the intricacies of San Francisco real estate. Starboard CRE brings decades of brokerage experience representing over 600 million square feet of space with an aggregate lease value of over 10 billion and investments sold over 3 billion.

CA DRE# 01103056

